

REV.	DESCRIPTION	DATE	BY	APPD.
C	NPR 2579	9/21/01	JMH	

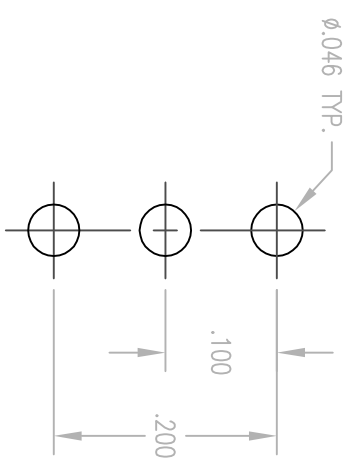
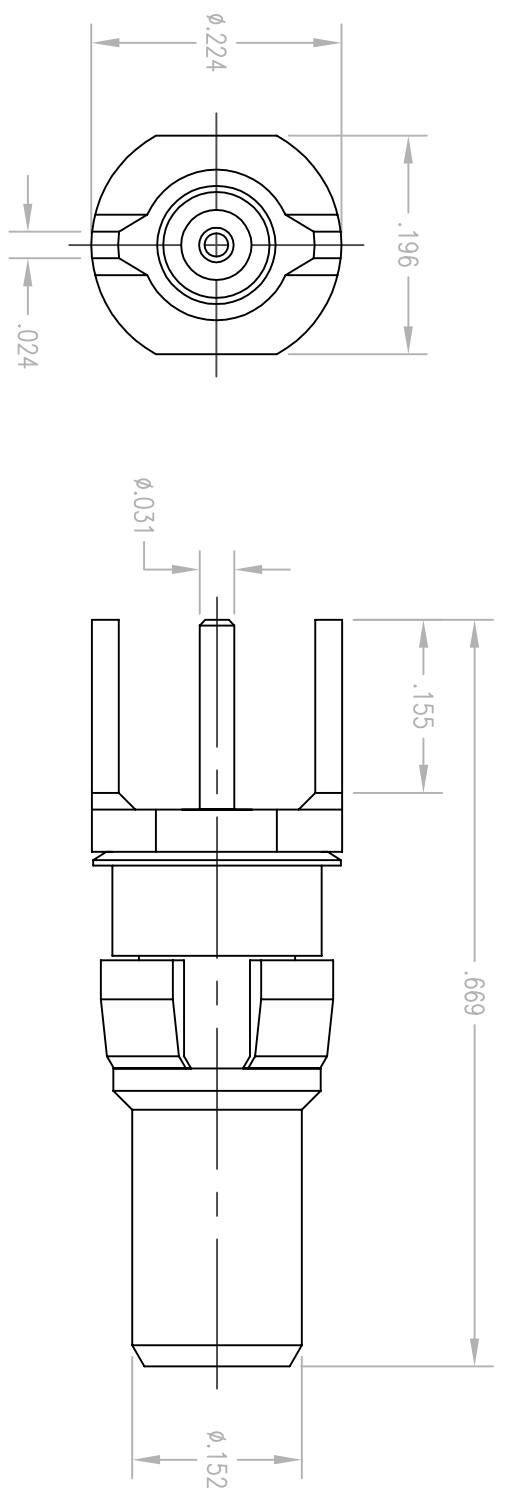

RECOMMENDED MOUNTING HOLE

- NOTES:
1. MATERIALS:  
 BODY: BRASS PER ASTM B16  
 CONTACT: COPPER ALLOY  
 INSULATOR: TEFLON PER ASTM D1710  
 CLIP RING AND SPRING WASHER: PHOSPHOR BRONZE PER ASTM B103
  2. FINISH:  
 BODY AND CONTACT: .000030 MIN. GOLD PER MIL-G-45204 OVER  
 .000050 MIN. NICKEL PER QQ-N-290  
 CLIP RING: .000100 MIN. NICKEL PER QQ-N-290 OVER  
 COPPER FLASH  
 SPRING WASHER: .000005 MIN. GOLD PER MIL-G-45204 OVER  
 .000050 MIN. NICKEL PER QQ-N-290

PER ASME Y14.5M-1994 UNLESS OTHERWISE SPECIFIED: TOLERANCES ARE IN INCHES (UM)		PER ASME Y14.5M-1994 UNLESS OTHERWISE SPECIFIED: TOLERANCES ARE IN MILLIMETERS (UM)	
DIMENSIONS: XX ± .01/0.254 DIMENSIONS: XXX ± .005/0.127		DIMENSIONS: XX ± .01/0.254 DIMENSIONS: XXX ± .005/0.127	
ANGLES: X° Z'		SCALE: 6:1	
CUSTOMER DRAWING		TITLE	
DRAWN: JMH DATE: 9/21/01		CHECKED: [ ] DATE: [ ]	
APPROVED: [ ] DATE: [ ]		APPROVED: [ ] DATE: [ ]	
A		200-010-6140G	
SHT. 1		OF 1	
REV. C		RDM STRAIGHT PLUG	
Litton Winchester/Reticon 400 Post Road Westford, Connecticut 06096		RDM STRAIGHT PLUG	